

C1-DP

DMR PORTABLE RADIO

KEY FEATURES

- Simplex / Semi Duplex Communication
- IP67 & IP68 Standard Compliance
- DMR TDMA 2 Slot
- AES 256 Bit Encryption
- Call Alert Decode
- Radio Check Decode
- Capability of being Killed/Un-killed
- CTCSS & DCSS
- AMBE +2 Vocoder
- Analog Mode, Digital Mode, Mix Mode Operations
- Scan, Priority Scan
- Channel Number Announcement
- Battery Level Announcement
- Battery Saver Mode
- Low Battery Alert
- Emergency Alarm (SOS)
- Man down, Lone Worker (Optional)
- Bluetooth, GPS, GIS (Optional)
- Voice Recording (Optional)

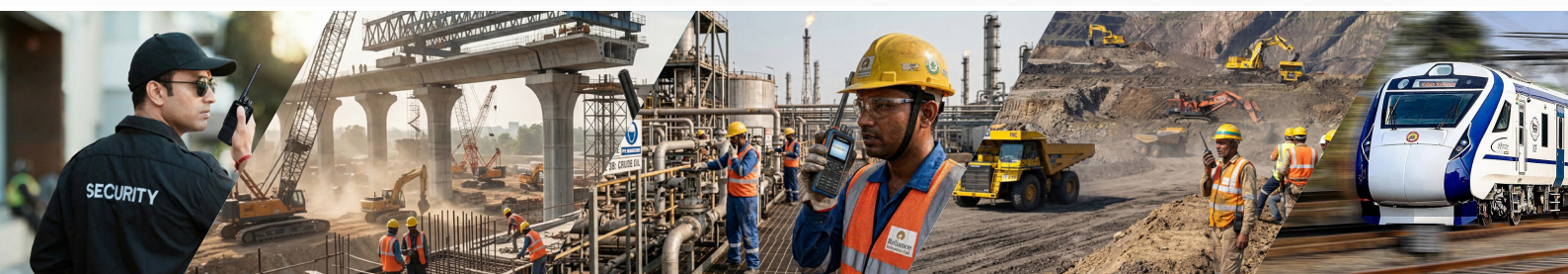

GENERAL

Parameter	Specification
Frequency Bands	136-174 MHz, 400-470 MHz
Channel Capacity	256
Zone Capacity	16
Channel Spacing	12.5kHz/25kHz
Operating Voltage	DC 7.4V ± 10%
Battery	2500mAh Li-ion(Standard), 3000mAh Li-ion(Optional)
Battery Life	Analog:16h; Digital:17h
Dimensions (HxWxD)	117.4x54x36mm
Weight	315g
Antenna Impedance	50Ω
Digital Protocol	ETSI-TS102 361-1,-2,-3
FM Modulation	11K0F3E @12.5kHz,16K0F3E @25kHz
4FSK Digital Modulation	7K60FXD(Data Only), 7K60FXE(Voice Only), 7K60FXW (Data and Voice)

ENVIRONMENT

Parameter	Specification
Dust & Water Protection	IP67 Standard, IEC 60529
Low Temperature / High Temperature	MIL STD 810 G Pro I, MIL STD 810 G Pro II
Salt Fog Test, Vibration Test, Dust Test, Temp. Shock Test, Low Pressure, Solar Radiation Test, Rain Test, Shock & Drop Test	MIL STD 810 G Pro I

TRANSMITTER

Parameter	Specification
RF Power Output	VHF: 1/5W, UHF: 1/4W
Frequency Stability	±0.5ppm
Modulation Limiting	±2.5kHz @12.5kHz, ±5kHz@25kHz
FM Hum & Noise	-40dB @12.5kHz
Adjacent Channel Power	-60dB @12.5kHz
Modulation Fidelity / AF Response	+1 ~ -3dB
Audio Distortion	1%
Modulation Sensitivity	8.2mv
Spurious Emission	70dB

RECEIVER

Parameter	Specification
Sensitivity (Analog)	0.18μV @12dB SINAD
Sensitivity (Digital)	0.18μV @BER 5%
Squelch Sensitivity	0.18μV
Adjacent Channel Selectivity	65dB
Spurious and Image Rejection	70dB
Inter-modulation	70dB
Rated Audio Power Output	1W
Rated Audio Distortion	2%
Audio Response/ AF Response	+1~-3dB
FM Hum & Noise	-40dB @12.5kHz
Digital Vocoder Type	AMBE+2

STANDARD ACCESSORIES

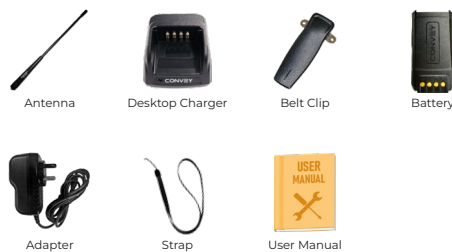

OPTIONAL ACCESSORIES

